

FEATURES

- Forged chambers
- Rigid construction
- Laser welded diaphragm
- Optional exotic materials

APPLICATION

- Separation systems
- Isolation applications
- Viscous & corrosive media
- High-pressure applications
- High vibration application

Direct Coupled



STANDARD SPECIFICATIONS

Range type	: -1...60 bar / 100...160 bar / 210...400 bar	:
Top chamber material	AISI 304 SS	
Diaphragm	: AISI 316L SS, laser welded on upper part	
Gaskets	: PTFE	
Bottom chamber material	: AISI 316 SS	
Instrument connection	: 1/2" NPT (F) / 1/2" BSP (F)	
Fill fluid	: Silicon DC 200 [-40°C to 200°C]	
Process connection	: 1/2"NPT (M) / 1/2" BSP (M)	
Assembly	: Direct	

DIMENSIONAL DRAWING

Type S01 [-1...60 bar]

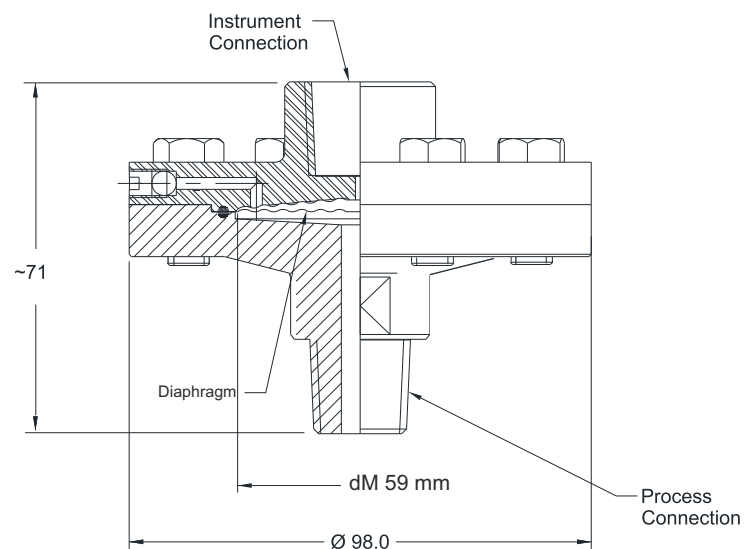

All dimensions are in mm.

DIMENSIONAL DRAWING

Type S02 [100...160 bar]

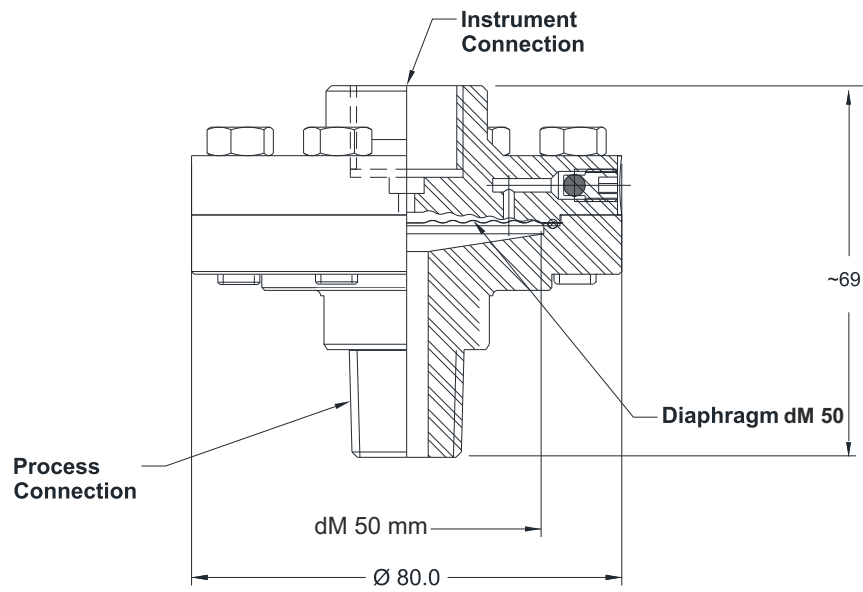

Type S03 [210...400 bar]

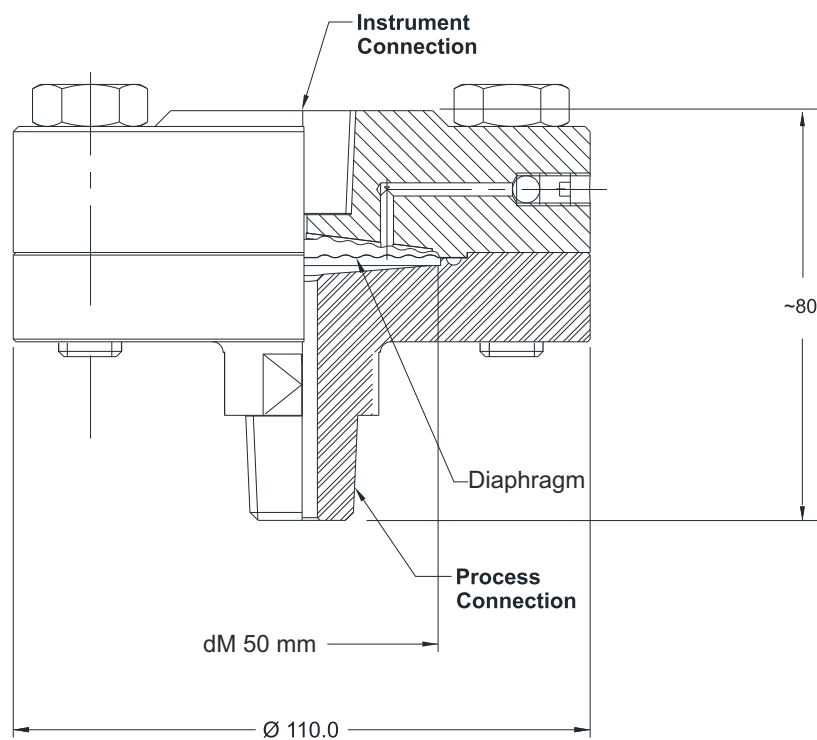

ORDERING CODES

1. RANGE TYPE

S01	-1...60 bar
S02	100...160 bar
S03	210...400 bar

2. TOP CHAMBER MATERIAL

LC	AISI 304 SS	LF	AISI 316 SS
LG	AISI 316L SS		

3. DIAPHRAGM MATERIAL

DG	AISI 316L SS	DM	Monel 400
DO	Hastelloy C-276	DQ	Inconel 600/625
DV	Titanium	DW	Tantalum
D9	Gold Plated	DP	PTFE (Max 10 BAR)
DP	Hastelloy C22		

4. GASKETS

RP	PTFE	RM	Metal*
-----------	------	-----------	--------

5. BOTTOM CHAMBER MATERIAL

NF	AISI 316 SS	NM	Monel 400
NG	AISI 316L SS	NV	Titanium
NO	Hastelloy C-276	N1	PVC
NQ	Inconel 600/625		
N4	Polypropylene		

(For different materials, contact factory)

6. INSTRUMENT CONNECTION

02B	1/4" BSP (F)	04N	1/2" NPT (F)
02N	1/4" NPT (F)	04B	1/2" BSP (F)

7. SEALING FLUID

OA	Silicon DC 200 [-40°C to 200°C]
OF	Food grade oil [-20°C to 140°C]
OI	Syltherm 800 [-40°C to 380°C]
OL	Silicon DC 710 [0°C to 250°C]
OG	HT 270 (PFPE) [-50 ... +250 °C]
OB	47V20 silicon oil [-50 ... +240 °C]

8. PROTECTION ON WETTED PARTS

PA	PTFE lining on bottom chamber
PB	PTFE protection for diaphragm
PC	PTFE coating on diaphragm and wetted parts

9. PROCESS CONNECTION

12B	1/4" BSP (M)	14N	1/2" NPT (M)
14B	1/2" BSP (M)	14M	M20 x 1.5 (M)
12N	1/4" NPT (M)	02N	1/4" NPT (F)
04N	1/2" NPT (F)	05N	3/4" NPT (F)
02B	1/4" BSP (F)	04B	1/2" BSP (F)
15N	3/4" NPT (M) Only 2 Piece Type		
15B	3/4" BSP (M) Only 2 Piece Type		
05N	3/4" NPT (F) Only 2 Piece Type		

10. HARDWARE

MC	AISI 304 SS
MF	AISI 316 SS

11. ASSEMBLY

B8	Direct
B9	Remote(capillary)

12. CAPILLARY

OU	AISI 304 SS	OV	AISI 316 SS
-----------	-------------	-----------	-------------

13. ARMOUR

OX	AISI 304 SS	OY	AISI 316 SS
OZ	PVC (Ambient max. 60°C)		

14. REMOTE MOUNTING LENGTH

XXXX	1000 mm up to 6000 mm
	(For longer lengths, contact factory)

15. OTHER OPTIONS

XZ	Dry seal
HL	Helium leak test
TM	Material test certificate 2.2
TC	Material test certificate 3.1
TN	Tested to NACE Standard
TQ	Hydrogen service (Consult factory)
TF	PMI Test
TG	IGC TEST
FP	Flushing connection available

Ordering Example : D101-S01-LC-DG-RP-NF-04N-OA-14N-XX-B8

NOTES:

1. PTFE lining max pressure 10 bar. Consult factory for details
2. Other sealing liquids are available, contact factory for further details.
3. All metal diaphragms are laser welded to the top chamber.
4. While choosing option PA for diaphragm DG, option PB has to be selected mandatory.
5. PTFE lining to be chosen on parallel threads.