



BOURDON
The Original by Baumer



Main Features

- For corrosive gasses and liquids
- Class 1 according to EN 837-1
- Wetted parts Stainless steel (MEX) or Monel (MEM)
- Lloyds Register Approval
- Option : liquid-filled for applications with pulsations or vibrations
- Option : case material 1.4404 (316L) for aggressive atmosphere

Applications

- Food & Beverage
- Laboratory & Medical
- Oil & Gas / Chemical
- Water & Waste water
- Energy
- Transportation & Logistics
- Machinery

Technical Data

| | | | | |
|---------------------|--|------------------------------------|---------------|---|
| Nominal size | 100 mm | | Bezel ring | Stainless steel 1.4301 (AISI 304) Option : stainless steel 1.4404 (AISI 316L) |
| Measurement range | MEX : | -1 ... 0 to 0 ... 1600 bar | Movement | Stainless steel |
| | MEM : | -1 ... 0 to 0 ... 600 bar | Window | Instrument glass |
| Pressure limitation | | | Window gasket | Elastomer |
| Ranges ≤ 600 bar | Steady : | 100% of full scale value | Dial | Aluminium, white |
| | Fluctuating : | 90% of full scale value | Pointer | Aluminium, black |
| | Short time : | 130% of full scale value | Temperature | Ambient : -20 ... +70°C Medium : -40 ... +200°C (not filled) For liquid filled version see ordering details. The case temperature must not exceed +70°C Storage : -40 ... +70°C |
| Ranges > 600 bar | Steady : | 75% of full scale value | Thermal drift | ± 0.4% F.S. / 10 K (reference : 20°C) |
| | Fluctuating : | 65% of full scale value | Safety | S1 according EN837-1 Pressure gauge with blow-out device |
| | Short time : | 100% of full scale value | | |
| Accuracy | Class 1 (according EN837-1) | | | |
| Protection rating | IP 65 (EN 60529) | | | |
| Process Connection | MEX : | Stainless steel 1.4404 (AISI 316L) | | |
| | MEM : | Monel 400 | | |
| Bourdon tube | MEX : | Stainless steel 1.4404 (AISI 316L) | | |
| | MEM : | Monel 400 | | |
| Case | Stainless steel 1.4301 (AISI 304) Option : Stainless steel 1.4404 (AISI 316L) | | | |

Options

| | |
|--|-----------|
| ATEX II2GDc-IM2c (Including window laminated safety glass) | Code 0078 |
| Adjustable micro metric pointer (P ≥ 1.6 bar) | Code 0678 |
| Adjustable friction pointer | Code 0679 |
| Window laminated safety glass | Code 0751 |
| Window polycarbonate | Code 0753 |
| Blow out disc at the back | Code 0760 |
| Restrictor screw Ø 0.5 (for fittings > 1/4") | Code 0771 |
| Stainless steel 1.4404 (AISI 316L) solid drawn Bourdon tube | Code 0816 |
| Lloyd's Register approval | Code 0827 |
| Accuracy class 0.6 (For pressure gauge not filled and P < 1000 bar) | Code 0840 |

To be ordered separately

| | |
|--|------------|
| Material certificate 3.1 EN10204 | Code Q1229 |
| Calibration certificate EN837-1 (5 points raising and 5 points falling) | Code Q1070 |

Dimensions - Types of mounting

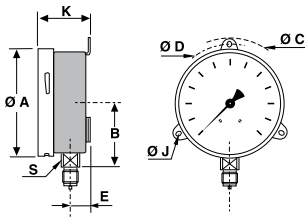

A (11)*

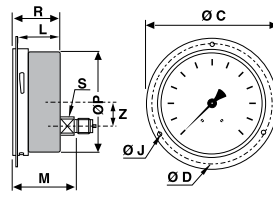

B (32)*

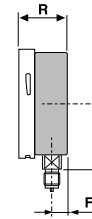

D (10)*

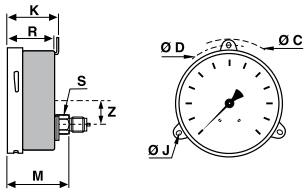

E (31)*

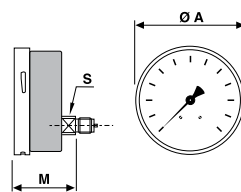

F (30)*

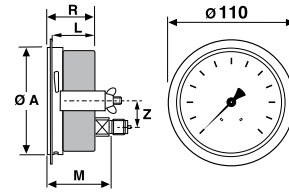

G (33)*

Weight (kg)
Filled : 0.81
Unfilled : 0.51

Panel cut-outs for types B and G = Ø 102 mm

*Type of mounting according to EN837-1 in brackets

| mm | A | B | C | D | E | F | J | K | L | M | P | R | S | Z |
|---------------|-----|----|-----|-----|------|----|-----|------|------|----|----|------|----|------|
| NS 100 | 101 | 67 | 134 | 118 | 21.5 | 17 | 5.5 | 54.5 | 44.5 | 64 | 99 | 50.5 | 22 | 31.5 |

Pressure ranges

| Code | Bar |
|------|-------------|
| B58 | -0.6 ... 0 |
| B59 | -1 ... 0 |
| B72 | -1 ... 0.6 |
| B74 | -1 ... 1.5 |
| B76 | -1 ... 3 |
| B77 | -1 ... 5 |
| B79 | -1 ... 9 |
| B81 | -1 ... 15 |
| B82 | -1 ... 24 |
| B12 | 0 ... 0.6 |
| B15 | 0 ... 1 |
| B16 | 0 ... 1.6 |
| B18 | 0 ... 2.5 |
| B19 | 0 ... 4 |
| B20 | 0 ... 6 |
| B22 | 0 ... 10 |
| B24 | 0 ... 16 |
| B26 | 0 ... 25 |
| B27 | 0 ... 40 |
| B29 | 0 ... 60 |
| B31 | 0 ... 100 |
| B33 | 0 ... 160 |
| B35 | 0 ... 250 |
| B38 | 0 ... 400 |
| B39 | 0 ... 600 |
| B41 | 0 ... 1 000 |
| B42 | 0 ... 1 600 |

| Code | kPa |
|------|----------------|
| D58 | -60 ... 0 |
| D59 | -100 ... 0 |
| D72 | -100 ... 60 |
| D74 | -100 ... 150 |
| D76 | -100 ... 300 |
| D77 | -100 ... 500 |
| D79 | -100 ... 900 |
| D81 | -100 ... 1 500 |
| D82 | -100 ... 2 400 |
| D12 | 0 ... 60 |
| D15 | 0 ... 100 |
| D16 | 0 ... 160 |
| D18 | 0 ... 250 |
| D19 | 0 ... 400 |
| D20 | 0 ... 600 |
| D22 | 0 ... 1 000 |
| D24 | 0 ... 1 600 |
| D26 | 0 ... 2 500 |
| D27 | 0 ... 4 000 |
| D29 | 0 ... 6 000 |
| D31 | 0 ... 10 000 |
| D33 | 0 ... 16 000 |
| D35 | 0 ... 25 000 |
| D38 | 0 ... 40 000 |
| D39 | 0 ... 60 000 |

| Code | kg/cm ² |
|------|--------------------|
| F58 | -0.6 ... 0 |
| F59 | -1 ... 0 |
| F72 | -1 ... 0.6 |
| F74 | -1 ... 1.5 |
| F76 | -1 ... 3 |
| F77 | -1 ... 5 |
| F79 | -1 ... 9 |
| F81 | -1 ... 15 |
| F82 | -1 ... 24 |
| F12 | 0 ... 0.6 |
| F15 | 0 ... 1 |
| F16 | 0 ... 1.6 |
| F18 | 0 ... 2.5 |
| F19 | 0 ... 4 |
| F20 | 0 ... 6 |
| F22 | 0 ... 10 |
| F24 | 0 ... 16 |
| F26 | 0 ... 25 |
| F27 | 0 ... 40 |
| F29 | 0 ... 60 |
| F31 | 0 ... 100 |
| F33 | 0 ... 160 |
| F35 | 0 ... 250 |
| F38 | 0 ... 400 |
| F39 | 0 ... 600 |
| F41 | 0 ... 1 000 |
| F42 | 0 ... 1 600 |

| Code | psi |
|------|-----------------|
| H59 | -30" Hg ... 0 |
| H73 | -30" Hg ... 15 |
| H75 | -30" Hg ... 30 |
| H2C | -30" Hg ... 60 |
| H78 | -30" Hg ... 100 |
| H79 | -30" Hg ... 150 |
| H81 | -30" Hg ... 220 |
| H82 | -30" Hg ... 300 |
| H13 | 0 ... 10 |
| H15 | 0 ... 15 |
| H1C | 0 ... 20 |
| H17 | 0 ... 30 |
| H19 | 0 ... 60 |
| H21 | 0 ... 100 |
| H22 | 0 ... 160 |
| H23 | 0 ... 200 |
| H25 | 0 ... 300 |
| H26 | 0 ... 400 |
| H27 | 0 ... 600 |
| H30 | 0 ... 1 000 |
| H31 | 0 ... 1 500 |
| H34 | 0 ... 3 000 |
| H38 | 0 ... 6 000 |
| H40 | 0 ... 10 000 |
| H41 | 0 ... 15 000 |
| H1D | 0 ... 20 000 |